

Central Minnesota Homes on Tour • Find Your Dream Home Today

TOUR OF HOMES



CENTRAL MINNESOTA BUILDERS ASSOCIATION

Two Weekends!
September 12-14
September 19-21

Friday 4:30-7 pm • Saturday & Sunday Noon-5 pm

CMBATour.com

Sponsored by



Scan the QR Code. Open the CMBA Tour App on your phone.



**BUILT TO YOUR SPECS.
BACKED BY OUR SERVICE.
MADE FOR BUILDERS.**



Every Thermo-Tech Window and Door is made to order to your specifications to make installation hassle-free. We know it's more than our reputation on the line, that's why our products are constructed with durable, low-maintenance vinyl and feature multiple energy-saving glass packages. And that's why we're with you every step of the way – from ordering to installation.

 **Thermo-Tech.**
Premium Windows and Doors



SCAN TO
LEARN MORE



877-565-0159 • ttwindows.com

CONSTRUCTION LOANS

made simple



Building your American Dream
is our American Heritage!



- Save thousands with one-time closing
- Lock your rate prior to construction
- Construction draws up to 18 months
- Preferred pricing for jumbo loans
- Local underwriting and loan servicing
- Also includes land and remodeling projects



AMERICAN HERITAGE BANK



TIM SMITH
NMLS# 533151
(320) 529-4230
TimS@LogBank.com

Ask me about

Homes for Heroes[®]

Our way to say Thank You
to Firefighters, Police, Teachers,
Military and Medical heroes!



Reflects terms available as of 2/4/2025. Subject to credit approval.

CONTENTS

- 6** 2025 CMBA Leadership
- 6** WELCOME message from 2025 CMBA President, Marty Czech
- 10** CMBA Building Community
- 16** Tour of Homes Builder Showcase
- 37** Tools for Schools Sponsors
- 35** 2025 Tour of Homes Committee
- 38** Advertisers Index



6
Welcome to the
2025 Fall Tour of
Homes

10 Building
Community



TOUR OF HOMES MAP
Pages 20-21

TOUR OF HOMES MODELS
Pages 22-34

TOUR OF HOMES

CENTRAL MINNESOTA BUILDERS ASSOCIATION



Two Weekends!

September 12-14 • September 19-21
Friday 4:30-7 pm • Saturday & Sunday Noon-5 pm

THANK YOU TO OUR SPONSORS:



/CMBA.MN
CMBAtour.com



@CMBAonline
CMBAonline.org



Scan the QR Code.
Open the CMBA Tour
App on your phone.



Collaborative Custom Design Experience



Custom home plans designed to fit your family's needs now and in the future

Beauty and function expressing your personality and lifestyle

Preferred by clients with a passion for design & detail



Design your DREAM HOME. Contact us today.

320.248.5580 • www.adsdesignsmn.com • info@adsdesignsmn.com

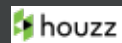

PIPER'S PLUMBING

of Central Minnesota
320-363-0379

**EXPERTS IN RESIDENTIAL
NEW CONSTRUCTION
AND REMODELING**

**FAST. RELIABLE.
AFFORDABLE.**

Service Calls
Residential New Construction
Light Commercial New Construction
Remodels
Tank & Tankless Water Heaters
Water Softeners

320-363-0379 • pipers@pipersinc.net • 30765 Pearl Drive, St. Joseph, MN

WELCOME



CENTRAL MINNESOTA
**BUILDERS
ASSOCIATION**



Marty Czech
2025 President

Premier Real Estate Services - Marty Czech

As the President of the Central Minnesota Builders Association, it is my distinct honor to welcome you to our 2025 Fall Tour of Homes! This event showcases 17 exquisite homes crafted by 12 of our member builders, with valuable contributions from our member subcontractors.

Serving as a Realtor in central Minnesota for over 20 years, with Premier Real Estate since 2011 and as a proud member of the Central Minnesota Builders Association, I am dedicated to making homeownership more accessible and helping to build a strong community. During my career I've seen a lot of market conditions, but I never anticipated that we would be faced with a housing shortage. Homeownership is not merely about having a place to live; it's about stability, opportunity, and the chance to build something enduring. One of our primary objectives at the CMBA is to help create more opportunities for Minnesotans to become homeowners by making new construction more affordable. We actively collaborate with local building officials, partners with Housing First Minnesota, and engage in committees and task forces focused on housing and construction.

The CMBA is also committed to helping build the next generation of trades workers through our Tools for Schools program and this year we provided over \$25,000 in grants to local schools to support their trades programs, thanks to our membership and their support and participation in a variety of our fundraising events.

Currently, the housing market faces challenges with demand for housing, surpassing our capacity to deliver affordable new homes. It is essential to communicate to our state and local leaders that homeownership is a value to our communities. If you are a builder, subcontractor, or professional in an allied field within the building industry and are not yet a member, I encourage you to reach out to me or the CMBA office to explore the benefits of joining our collective efforts.

This time of year, I eagerly anticipate the emergence of yellow signs signaling the beginning of two weekends filled with opportunities to engage with individuals interested in new homes in the fall tour.

Before you head out on the tour you can download the CMBA Tour of Homes app for additional information, photos, and directions. Dress appropriately for the weather and consider wearing slip-on shoes for convenience during your visit—please remember that socks are required, as bare feet are not permitted inside the homes!

Thank you and enjoy the 2025 Fall Tour of Homes!

Marty Czech

2025 CMBA President

Premier Real Estate Services - Marty Czech

CMBA Officers & Directors



Greg Wensmann
Builder Vice President
Wensmann Contractors LLC



Curtis Brown
Associate VP
Edward Jones



Jack Brandes
Past President
Lumber One, Avon



Stewart Swenson
Secretary
SUNCOM Development,
Construction, Management



LaNae DesRosier
Treasurer
SB Restoration Services, Inc.



Mitch Anderson
Director
Rinke Noonan



Jim Alvord
Director
Restore 24 LLC



Lance Barthel
Director
Batteries Plus Bulbs



Nate Moeller
Director
Paramount Construction



Ron Molitor
Director
Rice Companies



Brianna Torborg
Director
Falcon National Bank



Randy Weiher
Director
Erbauer Built, LLC

CMBA Staff



Wanda Schroeder
Executive Director



Steve Gottwalt
Government Affairs Consultant



Nikki Juntunen
Executive Assistant

Visit Us at Models #6, #8, #13, & #14



QUALITY BUILDING AT THE RIGHT PRICE!

Whether you're looking for your first home, your dream home or your retirement home, at Woodland Homes we will build it for you and we build it right. We only work with local, reputable subcontractors with the same focus on quality craftsmanship, building materials & products.



Craig Hiltner
Realtor/Sales/Design
320.250.8800
CraigHiltner@gmail.com

Rob Klaphake • 320.230.7700
WoodlandHomesOnline.com

MN Lic. 565225



Introducing West St. Cloud's NEWEST neighborhood!

Harvest Creek

Located minutes from St. Joseph and Sartell

Featuring
spacious
lots 0.32 to
2+ Acres!

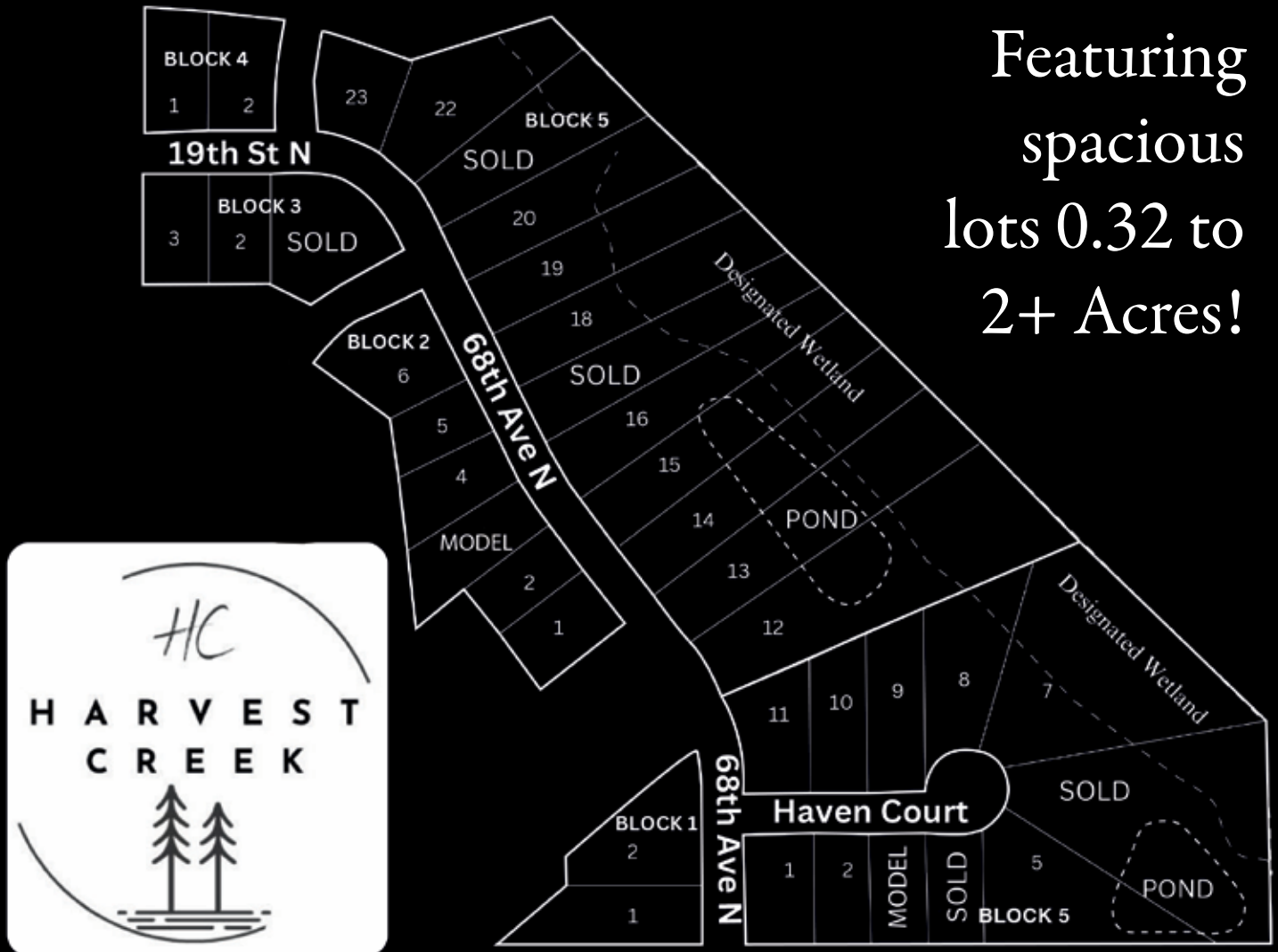

Lots priced from \$79,900 to \$119,900



Craig Hiltner
Realtor/Sales/Design
320.250.8800
CraigHiltner@gmail.com

Rob Klaphake • 320.230.7700
WoodlandHomesOnline.com

MN Lic. 565225





CMBA: Building A Stronger Homebuilding Community

*Article and Photos by
Central Minnesota
Builders Association*

Building, Advocating, Educating, Connecting with Programs and Events in the Community

The Central Minnesota Builders Association (CMBA) was established in 1971 by builders committed to enhancing professionalism and quality within the Central Minnesota homebuilding sector. Over the years, its membership has broadened to include builders, remodelers, subcontractors, suppliers, and other industry experts, all adhering to a defined code of ethics.

Mission & Purpose

- The CMBA strives to improve the Central Minnesota Building industry by Advocating for the industry at the local, state, and national levels.
- Educating our members about building industry best practices.

- Connecting our members in activities that strengthen competitiveness, professionalism, and the public’s confidence in our industry.

CMBA Programs & Events

Tools for Schools

This initiative supports local schools by providing tools, grants, scholarships, and resources to promote careers in building trades. CMBA donates grants to local high school industrial tech departments. An average of \$25,000–\$30,000 annually is provided to support of Central MN high schools, benefiting up to 21 schools at a time. CMBA also organizes creative fundraising events like the annual “Bags for Tools” bean bag tournament, where students create the boards for competition. Spectators can bid on or purchase the creative



board sets, with proceeds going back into the fund. This year's event raised nearly \$20,000 for the Tools for Schools Fund, thank you to the many sponsors that made the event a success. Student craftsmanship is highlighted at events like the Home Show, where items such as student-built park benches may be auctioned to raise awareness and funds.

Tour of Homes

Taking place each Spring and Fall, this event highlights homes built by CMBA builders. Attendees can discover new trends, amenities, and connect with builders at the homes or through a mobile app. It's perfect for anyone interested in new home construction, renovation inspiration, or innovative design features. The event offers hands-on exposure to real homes, allowing attendees to view flooring, cabinetry, garage layouts, landscaping, and modern amenities up close. It simplifies the process of comparing styles and trends while connecting with reliable local builders.

*Preceding page: Rise N Shine Meeting
This page clockwise: Sporting Clays Sponsor, Golf Sponsor, CMBA Picnic*

Article continued on page 14.

WW

Build Different

WERSCHAY
HOMES

Best of Houzz 10 Years Running
Werschayhomes.com





THE GATES
AT BLACKBERRY

WERSCHAY
HOMES

Luxury Living, Your Way

A golfer's paradise, just a swing away from the green.

At The Gates at Blackberry, every day feels like a getaway. Set along the Blackberry Ridge Golf Course, this community is a dream for golf lovers and those who appreciate refined living. Homes here are crafted with care, featuring timeless design, quality finishes, and scenic views that capture the beauty of each season. With spacious layouts and peaceful outdoor living, every home is thoughtfully designed to bring luxury and leisure together in perfect balance.

Build Different.

WerschayHomes.com

Article continued from page 11.

Home Show

A complimentary community event held in St. Cloud, the Home Show features local experts, product exhibits, demonstrations, and entertainment—ideal for homeowners planning remodels or new constructions. This free public event grants attendees’ access to trusted home-related professionals, products, and interactive experiences. It serves as the region’s primary resource for remodeling, landscaping, smart-home trends, and more. In 2025, over 3,000 visitors attended, and the CMBA hosted more than 90 exhibitors showcasing everything from solar panels and exterior upgrades to interior design and financial services. Registration for vendors is already underway for the 2026 Home Show, scheduled for March 13 & 14. For more details, visit cmbaonline.org.

Why a CMBA Member for My Next Project

One of CMBA’s primary goals is to inform consumers about how to find and collaborate with trustworthy contractors. The most qualified professionals often become members of industry associations. They actively seek opportunities to deepen their knowledge about their field, stay updated on current events and issues, engage in industry-specific training, and connect with fellow professionals. Additionally, they join to contribute back to their industries and communities by taking part in volunteer initiatives. They also act as advocates for change, aiming to influence legislative and regulatory policies that benefit the housing sector.

Explore the CMBA Directory on cmbaonline.org, to find your next partner for home projects.

Below: Sporting Clays

Right top to bottom: Bags for Tools Winners, Home Show Project, Day at the Capitol





AMERICAN DOOR WORKS
A REEDTOLK FAMILY COMPANY

Enhance the style and security of your home.

"It's so much more than a garage door"

Garage Doors • Garage Door Service & Repairs
Garage Screen Doors • Garage Door Openers & Accessories

www.americandoorworks.com
320-253-1310



EAST SIDE GLASS

- ▶ Specializing in custom heavy glass frameless shower enclosures
- ▶ Family owned and operated since 1953
- ▶ Several full size glass showers on display in our showroom

Showroom hours
8am-5pm M-F

Over 70 Years In Business! Since 1953.



We can easily replace moisture clouded glass in your existing windows!

Screen repair is easy!

305 Franklin Ave NE • St. Cloud MN, 56304
320-251-1900
www.eastsideglass-mn.com



DEERWOOD BANK

Deerwood Bank has flexible options for every homebuyer

Home Equity Loans

A smart way to fund renovations, consolidate debt, or cover major expenses

HELOCs

Flexible access to funds when you need them, perfect for ongoing projects

Bridge Loans

A helpful solution if you're buying before you've sold

Traditional Home Loans

Competitive mortgage options backed by local experts who know the market





Bethany Schwinghammer
Real Estate Lender
bethany.schwinghammer@deerwoodbank.com
320.257.3304
NMLS #796820

Jim Arnold
Real Estate Lender
jim.arnold@deerwoodbank.com
320.257.3317
NMLS #423382







Bulow Mn, Inc.
 Chris & Linda Bulow
 MN: BC741984
 11690 95th St. NE
 Otsego, MN 55330
612-219-8020
 bulowind@gmail.com
 bulowinc.com

Chris and Linda Bulow work as a team to build a wide range of homes with a special focus on one level living. Our goal is to provide outstanding customer service to you throughout the build of your home. We have a strong interest in the building industry and a long history of residential building and development expertise at Bulow MN, Inc. We will guide you through the process from start to finish.

Home #2



Elite Development, LLC
 MN: BC711080
 544 24th Avenue North
 St. Cloud, MN 56303
320-250-4588
 tylerkeller7@yahoo.com
 www.elitedevelopmentmn.com

Elite Development strives to deliver the best possible building experience with over 40 years of experience in the real estate, construction, and development industries. We have the ability to provide you with a seamless transaction. We believe the best way to build a home is to be honest and upfront. We will take the time to meet with you and assess your wants and needs; then sit down with a designer to create the best possible home plan for you. We are involved and hands on with each and every home that we build. We consistently monitor progress and make sure that our clients are kept up to date and involved in all decision-making processes.

Home #17



Lumber One Avon
 Jack Brandes
 MN: BC001820
 101 2nd St. NW
 Avon, MN 56310
320-356-7342
 jbrandes@lumber-one.com
 lumber-one.com

Lumber One Avon has been building homes in Central Minnesota for over 60 years. Our full service building center includes a retail lumber yard, interior design services, drafting services, and a retail hardware store and showroom. We pride ourselves on using the highest quality materials and experienced trade contractors. At Lumber One, we strive to bring honesty and integrity to all our interactions with customers, suppliers and coworkers. Check out our website for one of our many plans and info on all our developments.

Home #5



Berscheid Builders
 Rick Dingman
 MN: BC638971
 25 86th Street NW
 Rice, MN 56367
320-255-1412
 rick@berscheidbuilders.com
 berscheidbuilders.com

Berscheid Builders is comprised of a very skilled team of job supervisors, carpenters and sub-contractors that set us apart from any Central MN Builder. The experienced carpenters are the backbone of Berscheid Builders and take great pride in their work and carry the reputation of the company. Berscheid Builders is above all quality driven and exudes an excellent reputation in the local community.

Homes #12 & 15

**Building & remodeling in St. Cloud
and surrounding areas for over 40 years.**



dghomes-remodeling.com

320-251-9416

MN Lic: BC633099

**See our Tour Model #16
5815 Rivers Edge Drive, St. Cloud • Sauk River Estates Plat 5**



"Outstanding Neighborhood" on a very nice corner lot, this 1477 square foot 2-bedroom, 2 bath plus office/den with Double "Barn Door," home offers nicely finished raised "Entry" and living/dining ceilings. Cultured marble shower, vanity with two lavatory bowls, walk-in closet. Galley style kitchen with roll-out drawers, stainless steel appliances and nice island. Warm electric fireplace, 12x12 patio, fully sodded yard with sprinkler system, front area shrubbery with decorative rock, and concrete driveway. Other lots are available.

Additional home and lot packages starting at \$380's

These images are not part of Tour of Homes Model #16.



We work with you on every detail! Building a new home or addition, or remodeling?
Call to schedule your **FREE CONSULTATION!**





Smart'n Construction

Derek Mueller
Mn: BC726807
10 Main St E
Richmond, MN 56368
320-597-7300
derek@smartnconstruction.com
smartnconstruction.com

Derek Mueller has been serving the local building industry since 2005. He grew up on a small farm here in Central Minnesota, where his roots in a strong work ethic, integrity, and creativity were established. Derek has worked in the construction industry for 21 years and at Lifestyle Lumber for the past 14 years in sales and estimating, with that he is an expert in building materials and has a passion for design and building turnkey homes.

Homes #7 & 10



Woodland Homes

Robert Klaphake
MN: BC565225
22296th Street S
Sartell, MN 56377
320-230-7700
robklaphake@woodlandhomes.biz
woodlandhomesonline.com

Woodland Homes, Inc. was established in 2005 by Robert Klaphake. Over 20 years, Woodland Homes has become a leading residential builder in Central Minnesota. Woodland Homes has a network of trustworthy subcontractors & dedicated employees to help you realize your ideal home, start to finish, from design services to post sales services. With over 30 years of licensed contracting experience and more than 400 homes built, Rob has honed his practice of custom home building, and achieved an unmatched understanding of what clients want, expect and love of the finished product, making Woodland Homes a widely known and well-respected custom home builder in the central Minnesota area.

Homes #6, 8, 13 & 14



DG Homes & Remodeling, Inc.

Don Girtz
Mn: BC633099
P.O. Box 608
Sauk Rapids, MN 56379
320-251-9416
don@dghomes-remodeling.com
dghomes-remodeling.com

Building and remodeling has been a passion for Don and his staff at DG Homes & Remodeling since starting his business over 40 years ago. With the industry changing and constantly making things better, Don and staff stay deeply involved. "Hi, this is Don. What also keeps us going strong and still growing is the great feeling of accomplishment you get when you know you're doing your very best, and above that the rewarding appreciation received by our clients as their projects are being completed. Check us out and become part of our family of friends. Thank you! We hope to hear from you soon."

Home #16



Klein Builders, Inc.

Mark J. Klein
Mn: Bc008830
15703 Fruit Farm Road
St. Joseph Mn 56374
320-356-7233
kleinbuildersmn@gmail.com
kleinbuildersmn.com

Mark Klein has been building new custom homes in Central MN for 42 years. He is on the jobsite throughout the building process from start to finish. Klein Builders is dedicated to providing excellent quality, value and craftsmanship to all of their homes. Working closely with their clients ensures satisfaction and completion of their dream homes. They pride themselves on happy clients, repeat business and building homes that last a lifetime.

Home #9



Harren Companies, Inc.

Mark Harren
BC708204
20326 MN Hwy 15
St. Augusta, MN 55353
320-309-6455
mark@BuildwithHCl.com
BuildWithHCl.com

Founded in 2016, Harren Companies is a luxury custom home builder based in Central Minnesota. We craft distinctive homes, lakefront retreats, and thoughtful renovation, pairing meticulous planning with exceptional client service. Led by licensed Building Official and Qualified Builder Mark Harren, our team also specializes in post-frame and pre-engineered steel buildings for residential and light commercial projects. At Harren Companies, we believe building is more than construction – it’s about trust, experience, and creating spaces where families make lifelong memories.

Home #11



Schnettler Custom Builders

MN: BC374693
2137 Tamarack Drive
St. Cloud, MN 56301
320-309-8890
jason@schnettlercb.com
dan@schnettlercb.com
schnettlercb.com

Schnettler Custom Builders has been designing and building high-quality custom homes in Central Minnesota for over 40 years. We’re known for creative design solutions and exceptional client involvement, with many repeat customers over the years as our clients’ housing needs change. From concept to completion, we prioritize meticulous craftsmanship, stunning curb appeal, and energy efficiency; ensuring a truly one-of-a-kind home that exceeds expectations.

Home #4



Tenney Construction Services

Shaun Tenney
BC739859
1100 Madison Court
Sartell, MN 56377
320-224-9663
shaun@tenneyconstructionservices.com
tenneyconstructionservices.com

Tenney Construction Services, Inc. excels in providing top-notch general contractor services, ensuring smooth delivery of both new constructions and building renovations. Discover our commitment to quality and efficiency, designed to transform your building projects into landmark achievements.

Home #1



Schaefer Construction, LLC

April Schaefer
BC808965
St. Cloud, MN
320-492-2178
aschaefer076@gmail.com

At Schaefer Construction, we specialize in building custom homes that are modern, functional, and affordable. Founded in 2024 by April Schaefer, a St. Cloud native with experience in real estate and construction, her mission is simple: to create thoughtfully designed homes that fit real lives and real budgets. April brings a passion for design, quality craftsmanship and service to every project. Whether you’re a first-time homebuyer or ready to build your forever home, Schaefer Construction is your trusted partner in making it happen.

Home #3

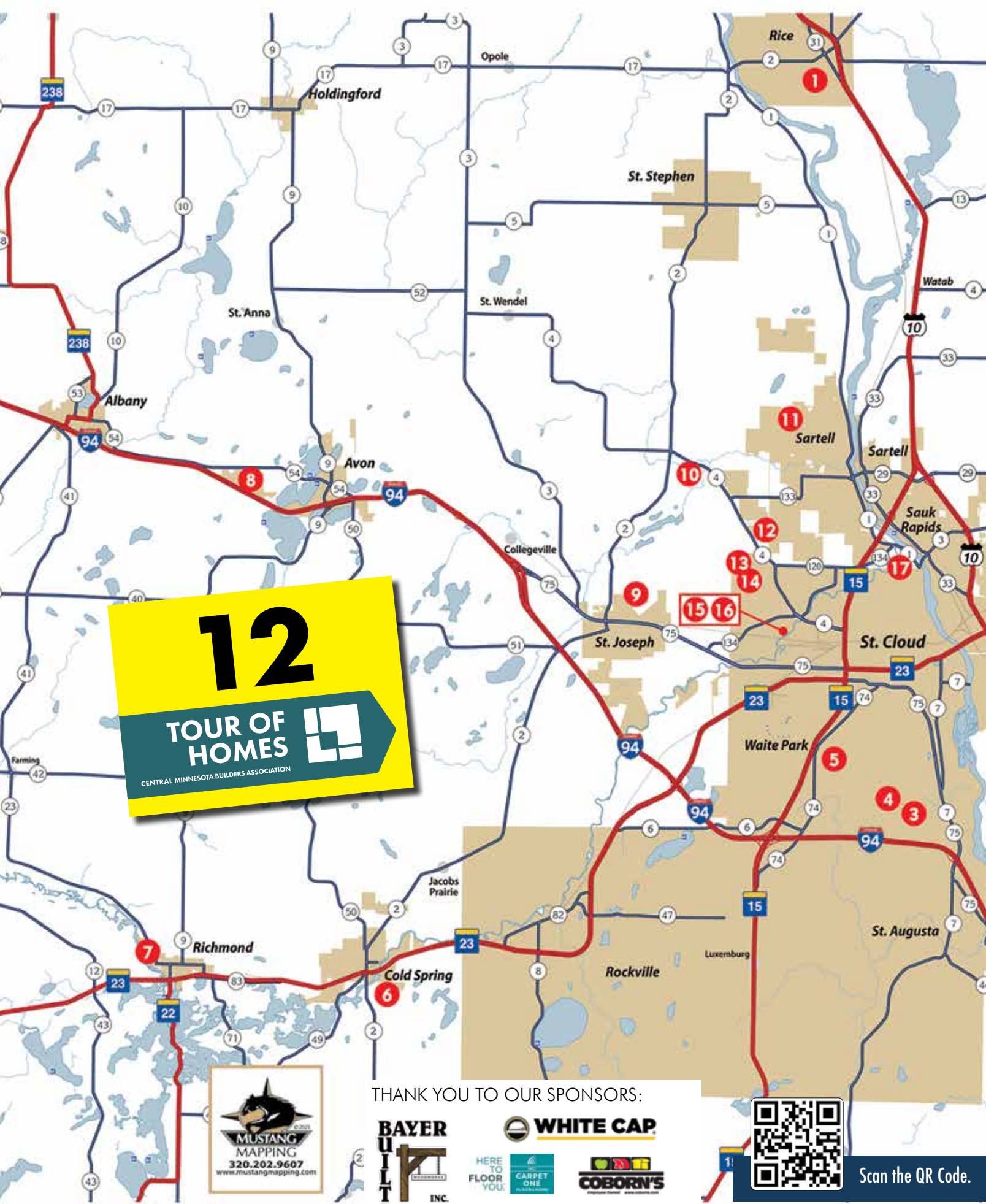

12

TOUR OF HOMES

CENTRAL MINNESOTA BUILDERS ASSOCIATION

THANK YOU TO OUR SPONSORS:



Scan the QR Code.

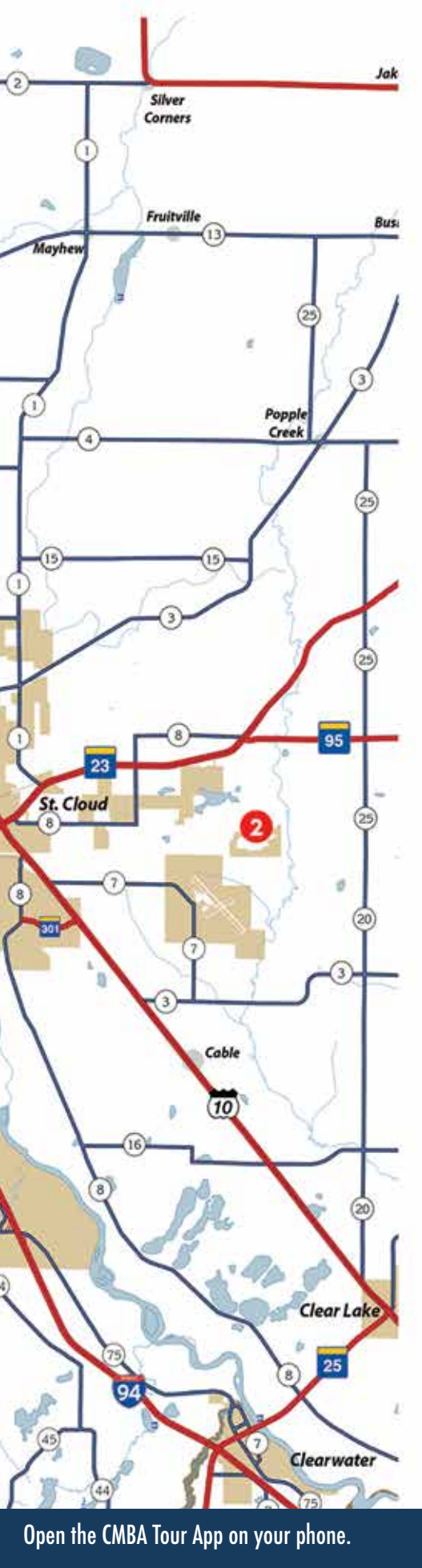

TOUR OF HOMES



CENTRAL MINNESOTA BUILDERS ASSOCIATION

September 12-14 • September 19-21
 Friday 4:30-7 pm • Saturday & Sunday Noon-5 pm

1 Teney Construction Services
 955 3rd Avenue SW
 Walnut Ridge Plat 4
 Rice

2 Bulow MN, Inc.
 5913 Rub of the Green St
 The Fairways 5th Addition
 St. Cloud

3 Schaefer Construction, LLC
 1699 39th Street S
 Coyote Creek
 St. Cloud

4 Schnettler Custom Builders LLC
 3524 Wildflower Road S
 Deer Creek Crossing East
 St. Cloud

5 Lumber One, Avon
 4252 30th Street S
 Stirling Waters
 St. Cloud

6 Woodland Homes
 76 Meadow Lane
 Blue Heron Heights 4th Addition
 Cold Spring

7 Smart'n Construction
 107 Barry Loop NW
 Barry Loop
 Richmond

8 Woodland Homes
 212 Woolgrass Way
 Avon Estates Southern View
 Avon

9 Klein Builders
 1303 Iris Lane
 Northland Heights
 St. Joseph

10 Smart'n Construction
 34168 83rd Avenue
 St. Joseph

11 Harren Companies
 904 13th Avenue N
 The Wilds
 Sartell

12 Berscheid Builders
 1932 Sandstone Loops S
 Sandstone Village 2
 Sartell

13 Woodland Homes
 6847 Haven Court
 Harvest Creek
 St. Cloud

14 Woodland Homes
 1958 68th Avenue N
 Harvest Creek
 St. Cloud

15 Berscheid Builders
 5948 Rivers Edge Drive
 Sauk River Estates Plat 5
 St. Cloud

16 DG Homes & Remodeling, Inc.
 5815 Rivers Edge Drive
 Sauk River Estates Plat 5
 St. Cloud

17 Elite Development
 2016 Forest Court
 Parkview Estates
 St. Cloud



/CMBA.MN
 CMBAtour.com



@CMBAonline
 CMBAonline.org

Open the CMBA Tour App on your phone.

1 955 3rd Avenue SW • Walnut Ridge Plat 4 • Rice



3 Beds | 2 Baths | 1,646 sq ft

DIRECTIONS Follow Hwy 10 North towards Rice, turn Left on 105th Street NW, turn Right on River Rd NE, turn Left onto 8th St SW, Left onto 3rd Ave SW.

TENNEY



320-224-9663

tenneyconstructionservices.com

Well planned one-level living home in the new and growing community of Walnut Ridge 4. The floor plan focuses on comfortable and convenient living with minimal maintenance. The vaulted ceilings and 9' walls give a bright and spacious feeling to the open concept design. The kitchen features premium granite countertop, high end appliance package and ample storage. The home boasts 3 bedrooms, and 2 bathrooms. In the primary suite, you will love the walk-in closet and private bathroom with dual sinks and master tub with tile shower surround. The patio offers a private and relaxing retreat equipped with in-ground sprinklers and no HOA. A huge bonus of this property is the finished and spacious gas heated three-stall garage that provides storage for all your needs. Other features of the home include gutters, sound insulated interior walls and solid doors.

Appliances	Karl's TV & Appliance	Lighting.....	Minnesota Lighting,
Building Materials	Simonson Lumber	Fireplace, Flooring	Showroom
Design.....	ADS Design	Millwork	Simonson Lumber
		Windows.....	Andersen Windows

2 5913 Rub of the Green Street • The Fairways 5th Add • St. Cloud



4 Beds | 3 Baths | 2,002 sq ft

DIRECTIONS From the West take 23 to 14th Ave SE – Right, this turns into 2nd Street SE turn Left on 55th Ave. SE turn Right on 2nd Street SE turn Right on Rub of The Green Street. House is on the Left on the Cul-de-sac.



612-219-8020

bulowinc.com



This elegant two-story home is located on Territory Golf Course. It has over 2000 s.f. finished, with 4 BR's, 3 bathrooms. The custom white kitchen cabinets have soft close features and a large center island. The owner's suite located upstairs has a private bathroom and an extra-large walk-in closet. There are 2 additional bedrooms upstairs with spacious closets and a shared bathroom. Laundry room is also located on the second floor for your convenience. Main floor bedroom can easily convert to a home office if needed. The fully finished & insulated 3-car garage with 8' tall garage doors are a great amenity to this home! Enjoy the view in the 14' x 12' screened in porch & the 14' x 12' patio! The landscaping has a full coverage sprinkler system and sod on the entire lot. The concrete driveway completes this quality home!

Appliances	Quality Appliance Center	Insulation.....	Metro Home Insulation
Counters	Custom Stone Interiors	& Waterproofing	
Garage Doors	Metro Home Insulation	Millwork	Bayer Built Woodworks
	& Waterproofing	Windows.....	Thermo-Tech Premium
			Windows & Doors



WestwindWoodworkers.com

320-685-4313 | 405 West Wind Court, Cold Spring

Follow us on social  

3 1699 39th Street S • Coyote Creek • St. Cloud



320-492-2178
aschaefer076@gmail.com

Discover a modern raised ranch with open flow, simple rooflines, & seamless indoor-outdoor living. Main level offers 2 beds, 1 bath, vaulted ceilings, natural sunlight, maple cabinets & trim, center island, stainless appliances & stylish fixtures. The owner's room has a huge walk-in closet with bath access for personal ensuite. Relax on the front deck or grill on the back patio. Expand by finishing the lower level to make it a 4 bedroom, 2 bath home!



2 Beds | 1 Baths | 2,120 sq ft

DIRECTIONS South on Cooper Avenue, turn Left on 39th Street South, house on the Left or from County Road 75/Roosevelt Road go West on 33rd Street South, Left on Cooper Avenue South, Left on 39th Street South, house on Left.

Building Materials	Simonson Lumber	HVAC	Finken Water Treatment, Plumbing, Heating & Cooling
Cabinets.....	Ron's Cabinets	Insulation.....	Citywide Insulation
Design.....	Schaefer Construction	Millwork.....	Trimpac
Electrical	Bertram Electrical	Plumbing	Finken Water Treatment, Plumbing, Heating & Cooling
Exteriors.....	Quad City Contracting		
Flooring & Lighting.....	Schaefer Construction		

4

3524 Wildflower Road S • St. Cloud • Deer Creek Crossing East



3 Beds | 3 Baths | 2,042 sq ft

DIRECTIONS South on Cooper Avenue South, straight through the roundabout at 33rd Street and continue onto Cooper Avenue S, turn Right on Wildflower Road S, the house is on the east side of the road.

CO-SPONSOR



Building MaterialsSimonson Lumber
 Cabinets..... Tischler Wood Products
 Counters C&D Granite
 Design..... Schnettler Custom Builders
 Electrical Gilk Services
 Exteriors.....Quad City Contracting
 Fireplace Minnesota Lighting, Fireplace
 Flooring Showroom

Flooring & Lighting..... Multiple Concepts
 Interiors, Carpet One
 Garage Doors American Door Works
 HVAC & Plumbing..... Gilk Services
 Insulation.....McPherson Products
 Windows.....Simonson Lumber



320-309-8890

jason@schnettlercb.com

dan@schnettlercb.com

Designed with an open concept floor plan, with a tray ceiling in the family room that flows into the spacious kitchen, dining area and back patio, ideal for indoor-outdoor living. Featuring 3 bedrooms and 3 bathrooms; a luxurious owner's suite with a private ensuite and custom closet, and guest bedroom with ensuite. Granite countertops, Andersen windows, and luxury vinyl plank flooring throughout. Comfort is guaranteed year-round with in-floor heat and forced air heating and cooling. The HOA provides lawn care and snow removal, plus pool access. Experience elegant living and effortless maintenance in the exceptional Deer Creek Crossing home.

5

4252 30th Street S • St. Cloud • Stirling Waters



3 Beds | 2 Baths | 1,655 sq ft

DIRECTIONS Head East on 33rd St from County Rd 74 turn North onto Stone Gate Drive then Take immediate Right onto Nottingham Road South. Follow for 1/3 mile then Turn Right onto 30th Street S, Home will be on Right.

AppliancesQuality Appliance Center
 Bath EnclosuresEast Side Glass Company
 Building Materials Lumber One, Avon
 Cabinets..... Westwind Woodworkers
 Closet OrganizationalMcPherson Products
 Counters C&D Granite
 Design.....ADS Design

Flooring Multiple Concepts Interiors,
 Carpet One
 HVAC & Plumbing..... Mechanical Brothers
 Lighting Multiple Concepts Interiors,
 Carpet One
 Millwork Bayer Built Woodworks
 Windows..... Andersen Windows



Lumber One Avon

320-356-7342

lumber-one.com

The newest Stirling Waters patio home model awaits! This spacious home has just over 1,800 square feet of finished floor space plus a screened porch overlooking a private pond! Home features include white oak interior doors, white painted enameled trim, in-floor heat, trendy light fixtures, custom pantry, large granite island, electric fireplace with shiplap surround, stainless steel appliances and much more. Step into the master bedroom which includes a trayed ceiling, large Andersen Windows, a private ensuite bathroom with double bowl vanity, tiled shower, and large walk-in closet. Home has two additional bedrooms, bathroom, mudroom/laundry, and ample storage throughout. Did we mention this home is part of an association? Sit back and let someone else handle all of your lawn care and snow removal!

*Building homes in
Central Minnesota for over 60 years!*



Developments

New Home
Builds

Material
Supplier



Avon (320) 356-7342 • Cold Spring (320) 685-3631
www.lumber-one.com



Best Home Builder
Thank you for your vote!

Find your nearest dealer online at
bayerbuilt.com



Exterior Doors.

Choose from hundreds of style options, all designed and built with premium components to meet the extreme and unpredictable conditions of the Midwest climate. **Upgrade your entry door, to an entry system...**

Acclimated **Entry Systems**



6

76 Meadow Lane • Cold Spring • Blue Heron Heights 4th Add



3 Beds | 2 Baths | 1,655 sq ft

320-230-7700

woodlandhomesonline.com

Walk in and appreciate the thoughtful layout and quality of this gorgeous new patio home in Cold Spring's Blue Heron Heights neighborhood! Vaulted ceilings, granite countertops & a generous sized pantry grace this elegant kitchen. Separate laundry room, tray ceiling in the primary bedroom, tile roll in shower, cozy fireplace, in-floor heat, and covered rear porch are also a few highlights to note in this beautiful patio home! Enjoy all your living space with the ease of no stairs!

DIRECTIONS Highway 23 to Cold Spring, at lights take 3rd Avenue SE to Rookery Drive, turn Right, follow Rookery Drive to Meadow Lane, turn Left.



CO-SPONSOR

Appliances	Quality Appliance Center	HVAC	Finken Water Treatment, Plumbing, Heating & Cooling
Building Materials	Lumber One, Avon	Lighting	Multiple Concepts Interiors, Carpet One
Exteriors.....	White Cap & QXO	Plumbing	Finken Water Treatment, Plumbing, Heating & Cooling
Flooring	Multiple Concepts Interiors, Carpet One		
Garage Doors	American Door Works		

7

107 Barry Loop NW • Richmond • Barry Loop



2 Beds | 2 Baths | 1,552 sq ft

320-597-7300

smartnconstruction.com

This beautiful patio home by Smart'n Construction is truly exceptional! As the last new build in the neighborhood, it completes the development with an HOA in the charming town of Richmond. This spacious 2-bedroom, 2-bathroom home features a 2-stall garage and a generously sized pantry perfect for all your storage needs. Enjoy the classic roll-in tile shower with a heated seat and heated floors in the bathroom. Custom cabinets and durable LVP flooring flow throughout the home, offering both style and comfort.

DIRECTIONS Follow Hwy 23 West towards Cold Spring, turn Right onto Grant Ave SW, turn Left onto Main Street, turn Right onto County Rd 23, turn Left onto 4th Street NW, Left onto Barry Ave NW, Left onto Barry Loop.

Building Materials	Lifestyle Lumber	Flooring	Cold Spring Carpet
Cabinets.....	Westwind Woodworkers	Insulation.....	Intex Insulating Company
Counters	C&D Granite	Landscaping	Smart'n Construction
Design.....	Smart'n Construction	Millwork	Bayer Built Woodworks
Exteriors.....	Lifestyle Lumber	Windows.....	Lifestyle Lumber

8

212 Woolgrass Way • Avon • Avon Estates Southern View



320-230-7700

woodlandhomesonline.com

Beautiful 2 bedroom + sunroom patio home in popular Avon Estates Southern View development. Generously sized owner's suite with private bathroom hosting dual sinks and roll in tile shower, walk in closet, functional design, and beautiful finishes expected from Woodland Homes, Inc. The 3-stall garage has an extra 5'x10' storage area. Landscape package included.



2 Beds | 2 Baths | 1,654 sq ft

DIRECTIONS From I-94, Avon exit, North on County Rd 9, thru downtown Avon, Left on County Rd 54 (1st Street NW), travel west to Estate Drive, turn South, at Woolgrass Way, turn Left (South).



Appliances	Quality Appliance Center	HVAC	Finken Water Treatment, Plumbing, Heating & Cooling
Building Materials	Lumber One, Avon	Lighting	Multiple Concepts Interiors, Carpet One
Exteriors	White Cap & QXO	Plumbing	Finken Water Treatment, Plumbing, Heating & Cooling
Flooring	Multiple Concepts Interiors, Carpet One		
Garage Doors	American Door Works		

9

1303 Iris Lane • St. Joseph • Northland Heights



320-356-7233

kleinbuildersmn.com

Beautifully crafted patio home featuring 3 bedrooms, 2 baths, and a spacious 3-stall garage with floor drain. The front porch enters to an open-concept floor plan with 9-foot ceilings and durable vinyl plank flooring throughout. The kitchen has custom knotty alder cabinetry, a large center island, granite countertops, stainless steel appliances, and a walk-pantry with countertop that doubles as a built-in safe room. The dining area opens to a concrete back patio, perfect for indoor/outdoor entertaining. Relax in the living room with a stunning electric fireplace with stone surround. A full second bath offers convenience for guests. The owner's suite is a true retreat, featuring a private ensuite with a roll-in tiled shower, custom dual-sink vanity, a large walk-in closet. The laundry room is fully equipped with a sink, cabinetry, and washer/dryer. Exterior highlights include steel siding with stone accents, a concrete driveway, in-ground sprinkler system, and a seeded/landscaped yard!



3 Beds | 2 Baths | 1,679 sq ft

DIRECTIONS Go West on Division Street, turn Right onto Northland Drive, turn Right onto Iris Lane NE.

Building Materials	Lumber One, Avon	HVAC	Mechanical Energy Systems
Concrete	Klein Builders	Plumbing	Pipers Plumbing of Central MN
Exteriors	White Cap	Window	Thermo-Tech Premium Windows & Doors

MARVIN 



Discover the View You've Been Waiting For with Marvin Windows at Simonson Lumber!

Build better with Simonson. Whether you're remodeling, building new, or just replacing old windows, **Marvin** delivers unmatched performance, energy efficiency, and timeless design.

- ✓ Sleek, modern frames
- ✓ Energy-efficient glass
- ✓ Built to handle Minnesota weather
- ✓ Expert advice from Simonson's knowledgeable staff

Simonson Lumber of Downtown St. Cloud
127 6th Ave N, St Cloud, MN 56303



[CONTACT US](#)



320-252-1920



INFO@SIMONSON-LUMBER.COM



4 Beds | 2 Baths | 2,496 sq ft

DIRECTIONS Go West on 8th Street North, at the roundabout take the second exit onto County Road 4, at the next roundabout continue on County Road 4 the house will be on the Left about 2 miles down.

Building MaterialsLifestyle Lumber MillworkBayer Built Woodworks
Design.....Smart'n Construction



320-597-7300

smartnconstruction.com

One of our most unique houses yet – this 2,496 square foot, 4-bed, 2-bath, 3-stall garage home is built entirely of precast concrete, including the roof. Designed for ultimate durability, sustainability, and energy efficiency, it features an open layout, exposed concrete interiors, repurposed materials, passive solar performance, and modern detailing that challenge traditional homebuilding norms.



5 Beds | 3.5 Baths | 3,232 sq ft

DIRECTIONS Driving North on Pinecone Road, turn Left on Central Park Blvd., turn Left on 13th Ave N and arrive. Driving West on 2 1/2 Street N, turn right on 13th Ave N, continue on 3/4 mile before arriving.

Building Materials Lumber One, Avon HVAC H&S Heating, A/C, Electrical & Plumbing
Cabinets..... Westwind Woodworkers Insulation.....CityWide Insulation
CountersC&D Granite Plumbing Pipers Plumbing of Central MN
Garage DoorsAugusta Garage Door Windows..... Thermo-Tech Premium
Windows & Doors



320-309-6455

BuildWithHCI.com

Stunning 3,232 square foot transitional farmhouse on the Sartell golf course. Features 5 beds, 3.5 baths, custom cabinetry with unique built-ins, granite tops, luxury vinyl plank flooring, stainless appliances, walk-in tile shower, and an electric fireplace. Spacious 3 car garage and refined finishes blend style and comfort for modern family living.

12

1932 Sandstone Loop S • Sartell • Sandstone Village 2



3 Beds | 2 Baths | 1,809 sq ft

DIRECTIONS Go West on 8th Street North, at the roundabout take the second exit onto County Road 4, turn Right onto Arbor Pkwy, turn Right onto Sandstone Loop.

CO-SPONSOR



- AppliancesKarl's TV & Appliance
- Building Materials Simonson Lumber
- Cabinets..... WestWind Woodworkers
- Design..... ADS Design
- ElectricalMechanical Energy Systems
- FlooringCold Spring Carpet
- Garage DoorsAmerican Door Works
- HVACMechanical Energy Systems
- Lighting.....Minnesota Lighting, Fireplace & Flooring Showroom
- PlumbingMechanical Energy Systems



Residential • Remodeling

320-255-1412

berscheidbuilders.com

A must-see Craftsman-style patio home, offering 1,809 sq. ft. of single-level living that blends functionality with style. Located in a premier Sartell neighborhood with association-maintained amenities, this home features 2 bedrooms, 2 bathrooms, a versatile flex room, and an innovative rear-alley 3-stall garage. Inside, rustic charm meets modern sensibility with warm oak cabinetry, quartz countertops, and an open-concept layout that connects the kitchen, dining, and great room. The centerpiece of the living area is a stone-surround electric fireplace, accented with a rustic mantle. Smart design continues with a mudroom drop zone off the rear entry. The owner's suite offers a peaceful retreat featuring an expansive walk-in closet and a spa-inspired bathroom with a ceramic tile walk-in shower.

13

6847 Haven Court • St. Cloud • Harvest Creek



3 Beds | 2 Baths | 1,655 sq ft

DIRECTIONS Take County Rd 4, Veteran's Drive Northwest to 322nd Street, turn Left (West), to 68th Avenue N, turn South, turn Right on Haven Court.

CO-SPONSOR



- AppliancesQuality Appliance Center
- Building MaterialsLumber One, Avon
- Exteriors..... White Cap & QXO
- Flooring Multiple Concepts Interiors, Carpet One
- Garage Doors American Door Works
- HVAC Finken Water Treatment, Plumbing, Heating & Cooling
- Lighting Multiple Concepts Interiors, Carpet One
- Plumbing Finken Water Treatment, Plumbing, Heating & Cooling



320-230-7700

woodlandhomesonline.com

Welcome to the Harvest Creek Development in West St. Cloud! Spacious lots and beautiful homes in this development are built exclusively by Woodland Homes, Inc. This model boasts a 4-car garage, 3 bedrooms, 2 bathrooms and a covered rear porch. Granite countertops in the kitchen, beautiful double vault, spacious pantry, and an electric fireplace are just a few highlights of the main area. Primary bedroom hosts a private 3/4 bathroom with a roll in tile shower, dual sinks, and walk in closet. Landscape package with a sprinkling system is included. Other home styles & lots available.

14

1958 68th Avenue N • St. Cloud • Harvest Creek



3 Beds | 3 Baths | 2,320 sq ft

320-230-7700

woodlandhomesonline.com

Woodland Homes welcomes you to their newest neighborhood – Harvest Creek! Uniquely designed patio home with bonus room above the three-stall garage. This light-filled home features beautiful maple cabinets & millwork. Relaxing front and rear covered porches, walk in pantry, granite countertops, cozy fireplace with stone accents, owner’s suite with tile roll-in shower, and 3’ wide doors. This landscaped yard is over 1/2 an acre. Other custom home styles & lots available.

DIRECTIONS Take County Rd 4, Veteran’s Drive Northwest to 322nd Street, turn Left (West), to 68th Avenue N, turn South, follow to home.



CO-SPONSOR

Appliances	Quality Appliance Center	HVAC	Finken Water Treatment, Plumbing, Heating & Cooling
Building Materials	Lumber One, Avon	Lighting	Multiple Concepts Interiors, Carpet One
Exteriors	White Cap & QXO	Plumbing	Finken Water Treatment, Plumbing, Heating & Cooling
Flooring	Multiple Concepts Interiors, Carpet One		
Garage Doors	American Door Works		

15

5948 Rivers Edge Drive • St. Cloud • Sauk River States Plat 5



320-255-1412

berscheidbuilders.com



2 Beds | 2 Baths | 1,860 sq ft

This beautifully designed patio home by Berscheid Builders, LLC, where timeless farmhouse touches blend seamlessly with craftsman tradition. Offering 3 bedrooms, 2 bathrooms, and 1,928 sq. ft., this home welcomes you with 9-foot ceilings. Step inside to a bright and open layout beginning with a welcoming foyer and coat closet, leading to a flexible guest suite. The knotty alder cabinetry paired with a quartz-topped island and integrated sink—a centerpiece in the kitchen that also features a generous walk-in pantry. Entertain in the adjacent dining room and spacious great room, complete with a modern electric fireplace. The owner’s suite, where luxury awaits with a spa-inspired, tile walk-in shower, a large closet, and direct access to the laundry room and mudroom for everyday convenience. Enjoy year-round cozy sunroom, framed by windows that connect you to the outdoors.

DIRECTIONS Take County Rd 4, Veteran’s Drive Northwest, turn Left onto Ridgewood Rd, turn Left onto Saukview Drive, turn Left onto Rivers Drive n bear Right on Rivers Edge Drive.



CO-SPONSOR

Appliances	Karl’s TV & Appliance	Garage Doors	American Door Works
Building Materials	Simonson Lumber	HVAC	Mechanical Energy Systems
Cabinets.....	WestWind Woodworkers Design.....	Lighting.....	Minnesota Lighting, Fireplace & Flooring Showroom
Electrical	Mechanical Energy Systems	Plumbing	Mechanical Energy Systems
Flooring	Cold Spring Carpet		

LOCAL LENDING POWER FOR NEW CONSTRUCTION, REMODELS, AND MORE

Whether you're building your dream home, planning a major remodel, or buying an existing home, Falcon National Bank is your one-stop mortgage solution.

- Construction loans up to 90% appraised value
- Conventional, FHA, VA, Rural Development loans
- Bare land financing
- Local team, personal guidance

Talk with a Mortgage Banker today and experience the power of local lending done right.



Jeb Willis
SVP of Mortgage Banking
NMLS #789498
320.968.6195
jwillis@falconnational.com



proudly local

REMARKABLY fresh to your table.

In 1921, Chester A. Coborn opened a one-room produce store in Sauk Rapids. He prided himself on owning a local business and focused on providing his neighbors with the high-quality goods they needed. That legacy is still strong today and we've stayed true to our roots through our 103-year history in the grocery business.

Today, Coborn's is your full-service employee-owned supermarket located across Central Minnesota. We strive to serve families and neighbors through career opportunities, offering local products and supporting our communities through a long and strong tradition that started over a century ago.

We're proud to support our wonderful communities who continue to support us because when you support your locally-owned businesses, you're supporting our larger community... and we all thrive together.

Local IS FRESHER. Fresher IS BETTER.

Employee Owned • coborns.com



2 Beds | 2 Baths | 1,477 sq ft

DIRECTIONS Take County Rd 4, Veteran's Drive Northwest, turn Left onto Ridgewood Rd, turn Left onto Saukview Drive, turn Left onto Rivers Drive.

CO-SPONSOR



320-251-9416

dghomes-remodeling.com

"Outstanding Neighborhood" on a very nice corner lot, this 1477 square foot 2-bedroom, 2 bath plus office/den with Double "Barn Door", home offers nicely finished raised "Entry" and living/dining ceilings. Cultured marble shower, double vanity lavatory bowls, walk-in closet. Galley style kitchen with roll-out drawers, stainless steel appliances and nice island. Warm electric fireplace, 12x12 patio, fully sodded yard with sprinkler system and front area shrubbery and rock, and concrete driveway. Other lots are available.

Appliances.....	Karl's TV & Appliance	Flooring & Lighting.....	Multiple Concepts Interiors, Carpet One
Building Materials.....	Simonson Lumber	Garage Doors.....	American Door Works
Cabinets.....	Brenny Custom Cabinets	HVAC.....	Mechanical Energy Systems
Counters.....	Brenny Custom Cabinets	Insulation.....	McPherson Products
Electrical.....	Mechanical Energy Systems	Landscaping.....	DG Homes & Remodeling
Excavating.....	J&S Excavating	Windows....	Thermo-Tech Premium Windows & Doors



3 Beds | 3 Baths | 1,943 sq ft

DIRECTIONS Follow Hwy 15 North, turn Right onto 12th St N, turn Left onto 29th Ave N, turn right onto Park Dr, turn Right onto 19th St N, turn Right onto Forest Drive, Left onto Forest Court.

CO-SPONSOR



320-250-4588

tylerkeller7@yahoo.com

Beautiful new one-level home with an open floor plan, 9' ceilings, high-end plank flooring, heated floors, and oversized windows that fill the space with natural light. The dream kitchen features an oversized island, granite countertops, custom cabinets, and a walk-in pantry. The living room boasts a floor-to-ceiling stone gas fireplace, vaulted ceiling, and a stylish ceiling fan. The master suite includes a spacious walk-in closet, custom no-step tile shower, and dual sinks. The fully finished, extra-deep garage offers 8' doors, a floor drain, in-floor heat, and an epoxy floor. Full landscaping is included, with in-ground sprinklers, concrete curbing, paver patio, and established trees and shrubs. Ideally located near Whitney Senior Center, Sauk River Regional Park, and Whitney Park with trails, playground, and picnic areas. Just one lot remains! Custom home packages available to build your dream home.

Appliances.....	Karl's TV & Appliance	Lighting.....	Minnesota Lighting, Fireplace, Flooring Showroom
Cabinets.....	Brenny Custom Cabinets	Plumbing.....	Finken Water Treatment, Plumbing, Heating & Cooling
Fireplace.....	Minnesota Lighting, Fireplace, Flooring Showroom	Windows....	Thermo-Tech Premium Windows & Doors
Flooring.....	Elite Development		
HVAC.....	Finken Water Treatment, Plumbing, Heating & Cooling		

TOUR OF HOMES



CENTRAL MINNESOTA BUILDERS ASSOCIATION

September 12-14 • September 19-21

Friday 4:30-7 pm • Saturday & Sunday Noon-5 pm

Tour of Homes Committee



David Werschay
Tour of Homes Chair
Werschay Homes, Inc.



Marty Czech
Premier Real Estate
Services - Mary Czech



Anthony Steinemann
ADS Designs



Jack Brandes
Lumber One-Avon



John Blenker
Westwood Professional
Services, Inc.



Ernie Wollak
Wollak Construction, Inc.



Pat Edelbrock
Woodland Homes, Inc.

THANK YOU TO OUR SPONSORS:



Tour of Homes Model Pricing

Price Range/Builder	Tour #
\$350,000-\$399,999	
Schaefer Construction, LLC 1699 39th Street South.....	3
\$400,000-\$499,999	
Tenney Construction Services 955 3rd Avenue SW, Rice.....	1
Woodland Homes Inc 76 Meadow Lane, Cold Spring.....	6
Smart'n Construction LLC 107 Barry Loop NW, Richmond.....	7
Woodland Homes Inc. 212 Woolgrass Way, Avon.....	8
Klein Builders 1303 Iris Lane, St. Joseph.....	9
DG Homes & Remodeling, Inc. 5815 Rivers Edge Drive, St. Cloud.....	16
\$500,000-\$599,999	
Bulow MN Inc 5913 Rub Of The Green Street, St. Cloud....	2
Lumber One, Avon, Inc. 4252 30th Street South, St. Cloud.....	5
Berscheid Builders, LLC 1932 Sandstone Loop S, Sartell.....	12
Woodland Homes Inc. 6847 Haven Court, St. Cloud.....	13
Woodland Homes Inc. 1958 68th Avenue North, St. Cloud.....	14
Berscheid Builders, LLC 5948 Rivers Edge Drive, St. Cloud.....	15
\$600,000-\$699,999	
Schnettler Custom Builders LLC 3524 Wildflower Road South, St. Cloud.....	4
Smart'n Construction LLC 34168 83rd Avenue, St. Joseph.....	10
Elite Development 2016 Forest Court, St. Cloud.....	17
\$800,000-\$899,999	
Harren Companies, Inc. 904 13th Avenue North, Sartell.....	11

When touring homes:
No food or drink inside homes
Wear socks • No shoes • No bare feet

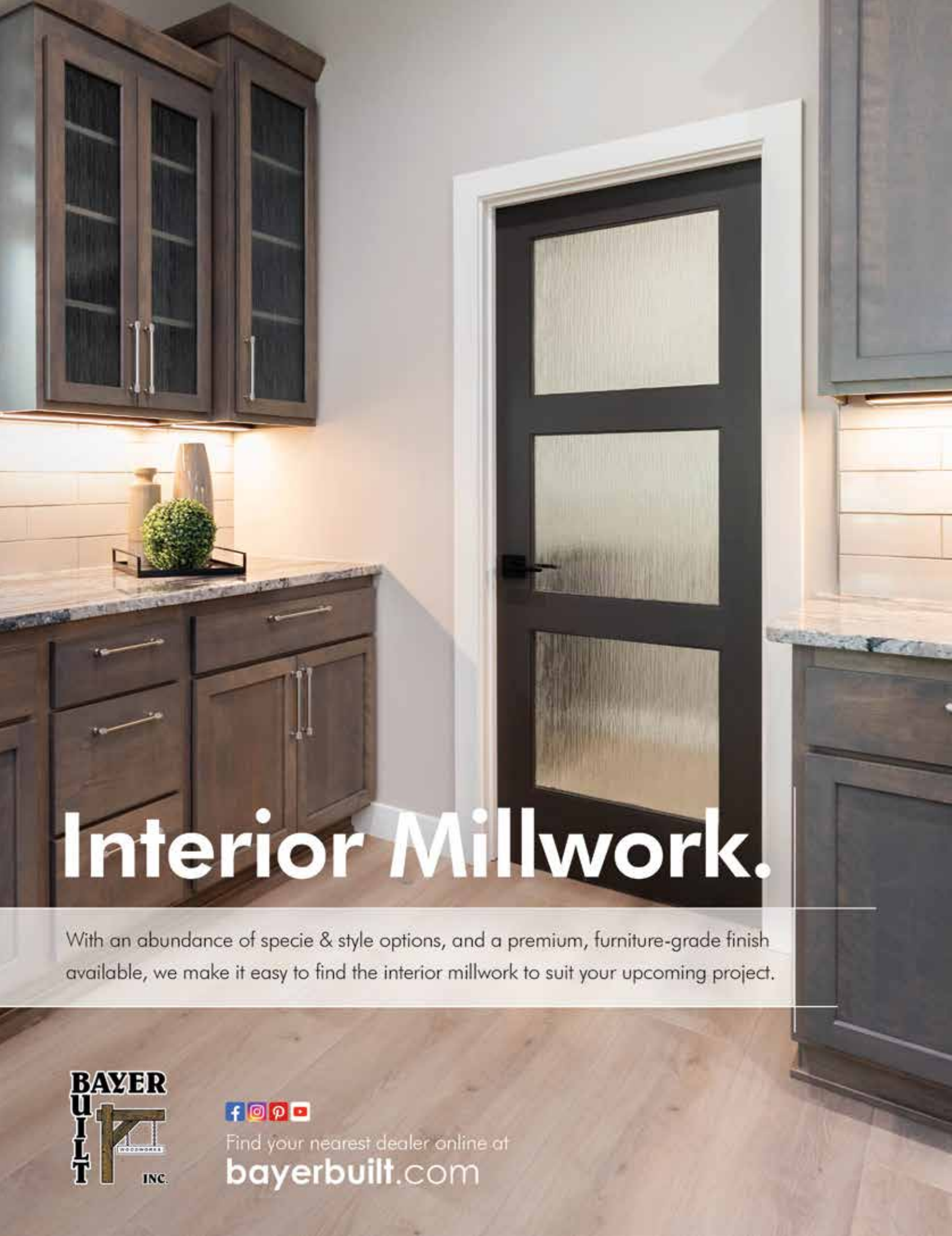

Interior Millwork.

With an abundance of specie & style options, and a premium, furniture-grade finish available, we make it easy to find the interior millwork to suit your upcoming project.



Find your nearest dealer online at
bayerbuilt.com

TOOLS FOR SCHOOLS

CENTRAL MINNESOTA BUILDERS ASSOCIATION



THANK YOU TO OUR 2025 SPONSORS



BAGS FOR TOOLS



TOUR OF HOMES APP

Search the app store for "CMBA Tour"

Free!

Use the camera on your phone to open the app with the QR Code



- The Latest Tour of Homes Event Information
- All Tour Model Info & Builder Info
- Save Your Favorites, Make Notes & More!



Plan your Tour of Homes trip and more!



Become a
CMBA Member
Today!

ADVERTISERS INDEX

Please take a moment to review the CMBA members and advertisers in this guide. Their support makes it possible for the CMBA Tour of Homes Guide to be shared with you in a printed and digital formats.

Guides can be picked up at **Coborns** and **Little Dukes** throughout Central Minnesota, at the CMBA office, and at all model homes.

ADS Design	5
American Door Works	18
American Heritage Bank.....	3
Bayer Built Woodworks....	26 & 36
Citywide Insulation	7
Coborns.....	33
Deerwood Bank.....	18
DG Homes & Remodeling Inc..	17
East Side Glass Company	18
Falcon National Bank.....	33
Knife River	7
Lumber One	25
Magnifi Financial Credit Union.....	Back Cover
Mid-State Tile Company, Inc ...	Inside Back Cover
Pipers Plumbing of Central MN..	5
Simonson Lumber	29
Thermo-Tech Premium Windows and Doors	Inside Front Cover
Tri County Abstract and Title Guaranty	7
Werschay Homes	12 & 13
WestWind Woodworkers.....	23
Woodland Homes.....	8 & 9

- Support and join others in advocating to protect and strengthen the building industry
- Stay on top of important legislative and regulatory affairs
- Get more workers in the building trades through CMBA's Tools for Schools program
- Exchange best practices with colleagues in the building industry
- Get Builders Continuing Education with your membership
- Make valuable, professional and personal connections at CMBA meetings and social events
- Showcase your products, services, expertise and skills at community showcases like the Tour of Homes and Home Show
- Market your business services and solutions



Scan the
QR Code
for a full listing of
your trusted
Central Minnesota
Community
Partners for your
commercial or
home needs.

MID-STATE TILE COMPANY



5th Generation Family owned.
92 years in business

320-252-1242

Ceramic Tile Sales and Installation

Serving Entire Area Since 1931

402 Lincoln Ave. NE
St. Cloud, MN 56304



Serving the community as a family business for more than 90 years
Proud members of the Central Minnesota Builders Association
& St. Cloud Area Chamber of Commerce



MAGNIFI WHAT MATTERS

Big plans deserve a better home loan.

Home construction
loans with only
one closing.

Lower down
payment with 90%
LTV financing.

Top-Rated
Mortgage Loan
Experience.



MAGNIFI[®]
FINANCIAL

magnifi.creditunion